

Unclassified

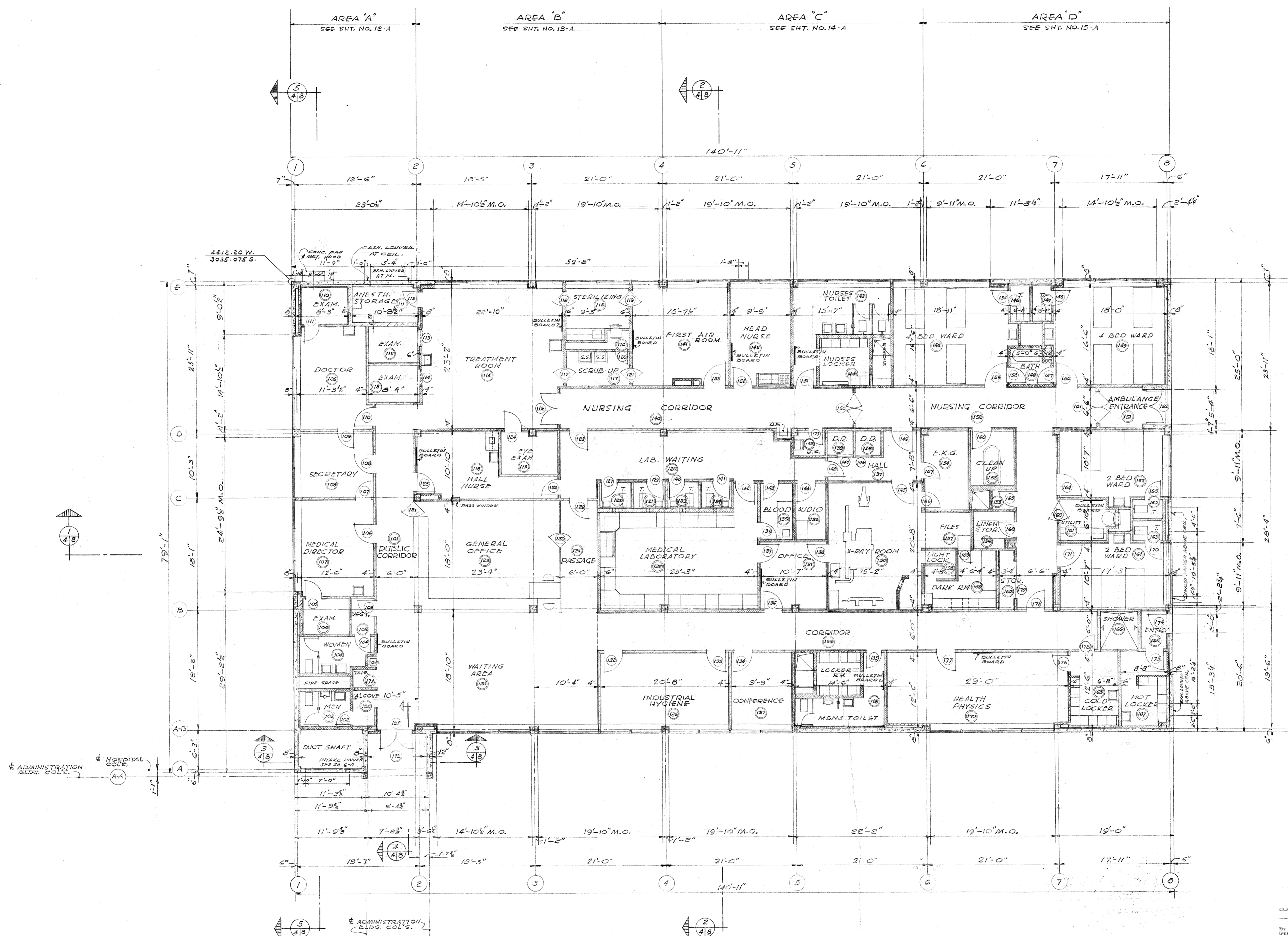

FIRST FLOOR PLAN
Scale 1/8" = 1'-0"

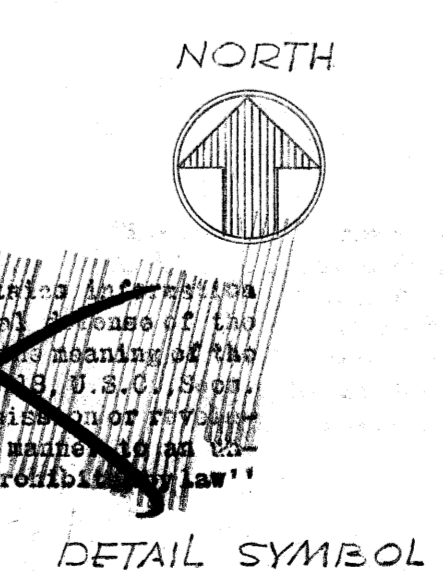
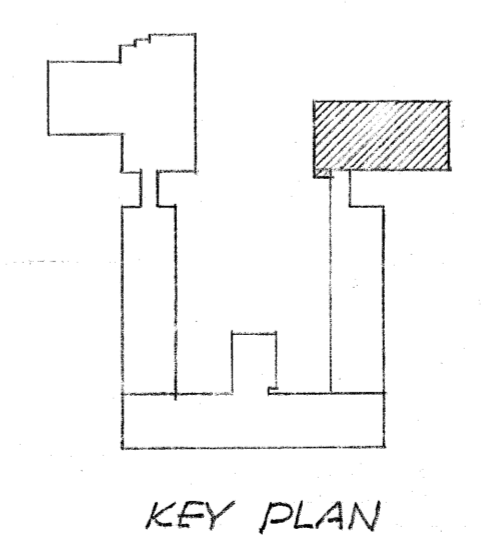

REVIEWED FOR CLASSIFICATION
KW 06/05/2014
Initials Date
UNCLASSIFIED

CLASSIFICATION CHANGED TO **Unclassified**

1ST REVIEWER: *[Signature]* DATE: *12/12/97*

2ND REVIEWER: *[Signature]* DATE: *2/12/98*

3RD REVIEWER: *[Signature]* DATE: *2/12/98*

4TH REVIEWER: *[Signature]* DATE: *2/12/98*

5TH REVIEWER: *[Signature]* DATE: *2/12/98*

6TH REVIEWER: *[Signature]* DATE: *2/12/98*

7TH REVIEWER: *[Signature]* DATE: *2/12/98*

8TH REVIEWER: *[Signature]* DATE: *2/12/98*

9TH REVIEWER: *[Signature]* DATE: *2/12/98*

10TH REVIEWER: *[Signature]* DATE: *2/12/98*

11TH REVIEWER: *[Signature]* DATE: *2/12/98*

12TH REVIEWER: *[Signature]* DATE: *2/12/98*

13TH REVIEWER: *[Signature]* DATE: *2/12/98*

14TH REVIEWER: *[Signature]* DATE: *2/12/98*

15TH REVIEWER: *[Signature]* DATE: *2/12/98*

16TH REVIEWER: *[Signature]* DATE: *2/12/98*

17TH REVIEWER: *[Signature]* DATE: *2/12/98*

18TH REVIEWER: *[Signature]* DATE: *2/12/98*

19TH REVIEWER: *[Signature]* DATE: *2/12/98*

20TH REVIEWER: *[Signature]* DATE: *2/12/98*

BT Images, Inc.
00000903

FOR INFORMATION ONLY

REV. NO.	DATE	ISSUED FOR	BY	APP. DATE
11	10-27-53	AS BUILT		10-27-53
10	6-8-53	DEV. REC. NO. 952-ASH		
9	5-11-53	DEV. REC. NO. 926-AM, 926-AF, 926-A		
8	3-19-53	DEVIATION REQUEST NO. 830-A		
7	1-12-53	DEVIATION REQUEST NO. 704-A		
6	4-21-52	DEVIATION REQUEST NO. 538		
5	4-3-52	DEVIATION REQUEST NO. 489		
4	3-27-51	DEVIATION REQUEST NO. 344		
3	2-6-51	DEVIATION REQUEST NO. 308		
2	10-20-51	CONSTRUCTION "B"		9-20-51
1	9-12-51	A & C APPROVAL		

UNITED STATES
ATOMIC ENERGY COMMISSION

SMITH, HINCHMAN & GRYLLS, INC.
ARCHITECTS & ENGINEERS
DETROIT 26, MICHIGAN

DRAWING TITLE
FLOOR PLAN

DRAWING APPROVED—DATE	DRAWINGS APPROVED—DATE	DRAWING APPROVED—DATE
<i>[Signature]</i> 9-20-51	L.A. WALKER 9-20-51	R.J. BROWN 9-20-51

DRAWN	CHECKED	DATE	JOB
R.E. SCHMITT	D.E. SCHMITT	9-20-51	8768

PROJECT: "C" PLANT
BUILDING: DISPENSARY C-102
SHEET: B3-4-A

UNCLASSIFIED